

RVH9106

COLOR STAINLESS STEEL
APRON-FRONT WORKSTATION SINK

RUVATI[®]
SPECIFICATION SHEET

MATERIAL

True 16 Gauge Thickness
Premium T304 Grade Stainless Steel
Nano-PVD colored finish: easy to clean, and long lasting



FEATURES

- Heavy duty sound guard padding and undercoating
- Slanted bottom with elegant drain grooves for easy draining
- Rounded inside corners



COLOR OPTIONS

BL: Black Stainless Steel

GG: Matte Gold Brass Tone

IN THE BOX



Basket Strainer
[RVA1022BL / GG]

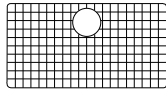

Rinse Grid
[RVA69100]

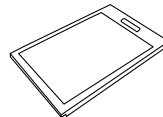

Cutting Board
[RVA1217AQ]

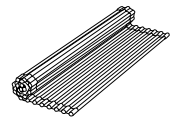

Rollup Rack
[RVA1385BL / GG]

NOMINAL DIMENSIONS

Exterior: 30" (wide) x 22" (front-to-back)

Interior Bowl: 28" (wide) x 16" (front-to-back)

Bowl Depth: 9"

Minimum Cabinet Size: 33" wide

Drain Hole Size: 3½"

Installation Type:
Apron-Front

Inside Corners:
Rounded

Drain Location:
Rear Center

Lorem ipsum

RUVATI USA

www.ruvati.com

Phone: 1.855.478.8284
Email: support@ruvati.com

OPTIONAL ACCESSORIES (SOLD SEPARATELY)

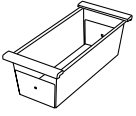

Colander
[RVA1317BL/GG]



Condiment
Serving Tray
[RVA1377BWC]

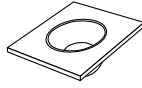

Mixing Bowl
and Platform
[RVA1288BWC]



Caddy
[RVA1580]

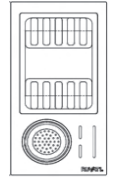

Drying Rack
[RVA1542BWC]

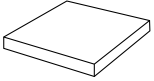

Butcher Block
[RVA2445ACA]

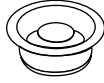

Garbage
Disposal Flange
[RVA1041BL/GG]



Deep Basket
Disposal Flange/Stopper
[RVA1052BL/GG]



Deep Basket Strainer
and Stopper
[RVA1027BL/GG]

DIMENSIONS

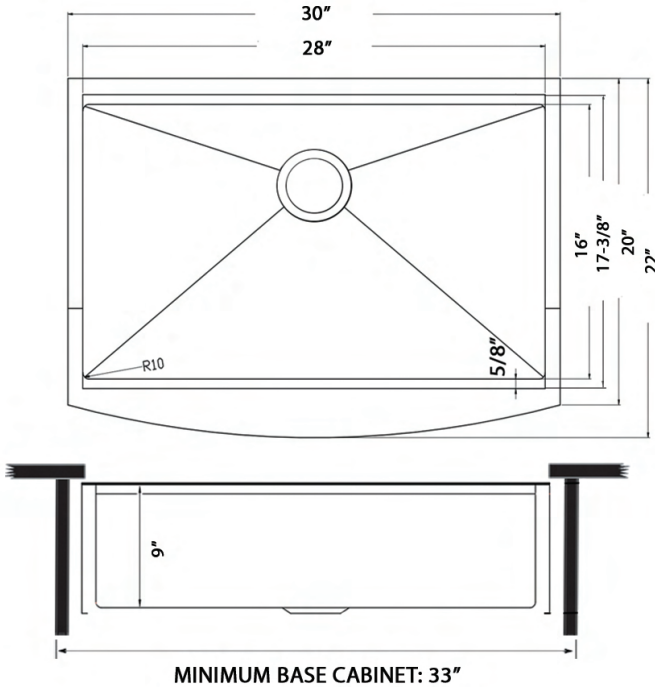

cUPC certified by IAPMO
to meet US and Canada
plumbing standards.



**SCAN TO REGISTER
YOUR WARRANTY**

or visit
ruvati.com/register

RUVATI USA
www.ruvati.com

Phone: 1.855.478.8284
Email: support@ruvati.com