

# RVG1650

GRANITE DUALMOUNT KITCHEN SINK

**RUVATI**<sup>®</sup>  
SPECIFICATION SHEET

## MATERIAL

- Solid Granite Composite
- 80% crushed natural granite for extreme strength
- Non-porous and resistant to stains

## FEATURES

- Naturally sound proof
- Will never discolor
- Rounded inside corners

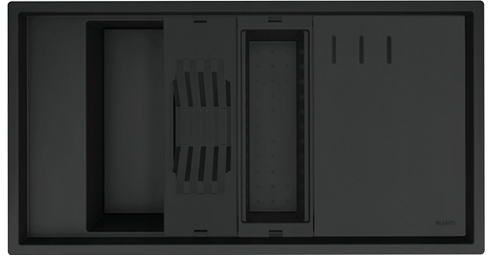

## COLOR OPTIONS

**BK:** Midnight Black

**WH:** Arctic White

## IN THE BOX

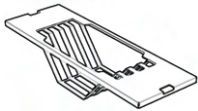

Dish Drying Rack  
[RVA1362BLK]



Cutting Board  
[RVA1261BLK]

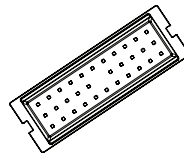

Collander  
[RVA1364BLK]



Basket Strainer  
[RVA1038BL/WH]



Rinse Grid  
[RVA41033]



Mounting Clips  
[RVA11052]



Cut-out  
Template

## NOMINAL DIMENSIONS

**Exterior:** 33-7/8" (wide) x 18-1/8" (front-to-back)

**Interior Bowl:** 27-1/4" (wide) x 15-1/2" (front-to-back)

**Bowl Depth:** 9-1/4"

**Minimum Cabinet Size:** 36" wide

**Drain Hole Size:** 3 1/2"

## Installation Type:

Dualmount

## Inside Corners:

Rounded

## Drain Location:

Left

**RUVATI USA**

www.ruvati.com

Phone: 1.855.478.8284  
Email: support@ruvati.com

## OPTIONAL ACCESSORIES (SOLD SEPARATELY)



Deep Basket  
Disposal Flange  
[RVA1049BL /GG]

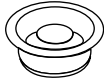

Garbage  
Disposal Flange  
[RVA1041BL /GG]



Deep Basket Strainer  
and Stopper  
[RVA1027BL /GG]

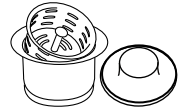

Deep Basket  
Disposal Flange/Stopper  
[RVA1052BL /GG]

## DIMENSIONS

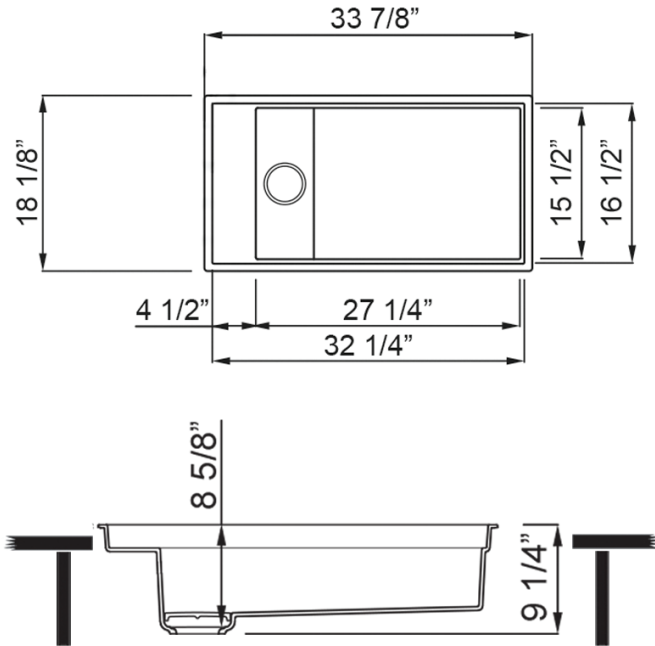

MINIMUM BASE CABINET: 36"



cUPC certified by IAPMO  
to meet US and Canada  
plumbing standards.



SCAN TO REGISTER  
YOUR WARRANTY

or visit  
[ruvati.com/register](http://ruvati.com/register)

**RUVATI USA**  
[www.ruvati.com](http://www.ruvati.com)

Phone: 1.855.478.8284  
Email: [support@ruvati.com](mailto:support@ruvati.com)